

Single Seal Terminals

Series 1000



AN HCC INDUSTRIES
COMPANY **hcc**



HERMETIC SEAL CORP.

NUMBERING SYSTEM

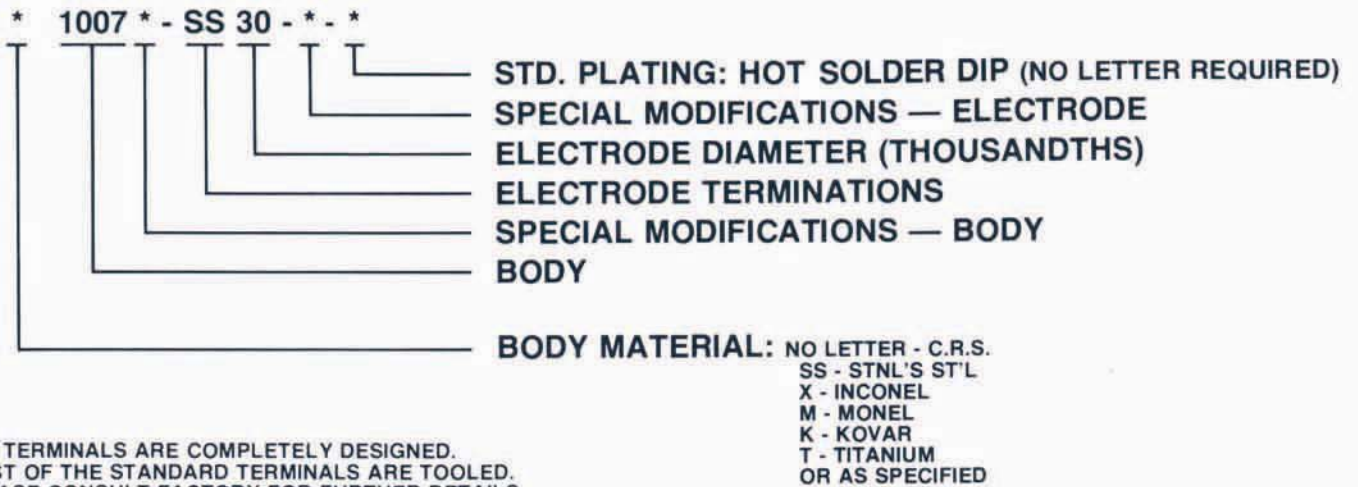

ALL TERMINALS ARE COMPLETELY DESIGNED.
 MOST OF THE STANDARD TERMINALS ARE TOOLED.
 PLEASE CONSULT FACTORY FOR FURTHER DETAILS.

TERMINALS



A multitude of materials, body sizes and termination configurations makes the 1000 Series a work horse in the single terminal field. Small in size, but rugged under extreme environments. Many special configurations are available from the factory.

GENERAL SPECIFICATIONS

SEAL (HERMETICITY)
 LEAKAGE RATE LESS THAN
 1×10^{-8} cc/sec AT 15 P.S.I.

THERMAL SHOCK
 NO EVIDENCE OF DAMAGE DETRIMENTAL
 TO THE OPERATION OF TERMINAL AT
 -65°C (-85°F) TO +125°C (+257°F)

INSULATION RESISTANCE
 GREATER THAN 10,000 MEGOHMS
 AT 500 VDC PER MIL-STD-202
 METHOD 302

CORROSION
 TERMINALS WILL MEET SALT SPRAY
 TEST PER MIL-STD-202, METHOD 101.
 (Depending on Plating)

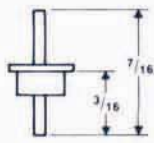

SS30

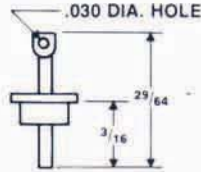

PS30

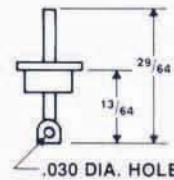

SP30

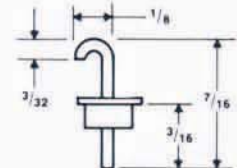

HS30

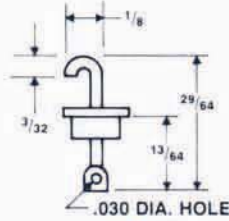
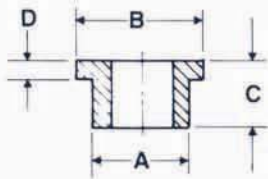

HP30

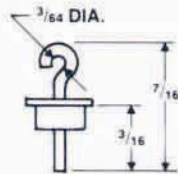

LS30



LP30

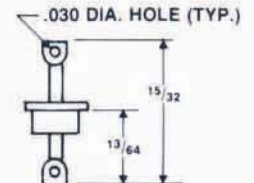

PP30

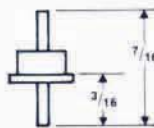

SS30R

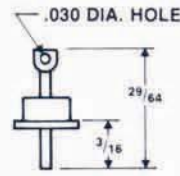

PS30R

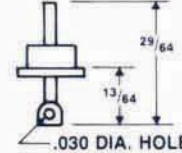

SP30R

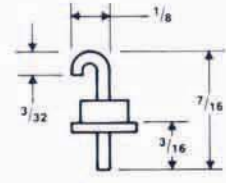

HS30R

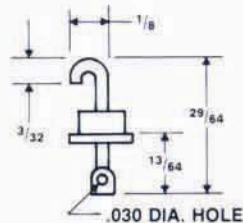
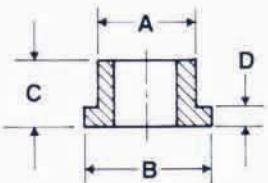

HP30R

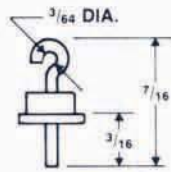

LS30R

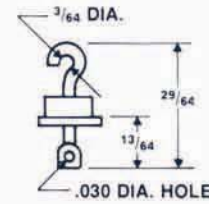

LP30R

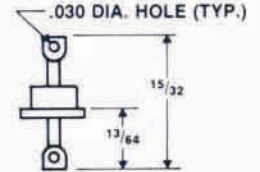

PP30R

.030 DIA. ELECTRODE

BODY	A	B	C	D	VOLTAGE R.M.S.
1007	.070	.082	.050	.010	500
1021	.093	.102	.055	.005	750
1011	.105	.115	.062	.005	900
1006	.112	.135	.075	.015	1200

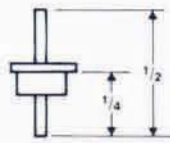
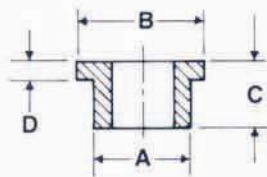

SS40

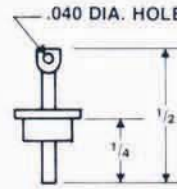

PS40

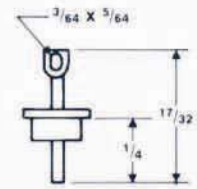

ES40

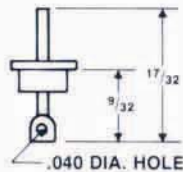

SP40

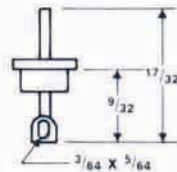

SE40

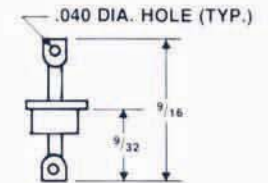

PP40

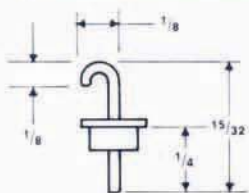

HS40

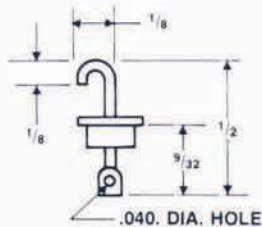

HP40

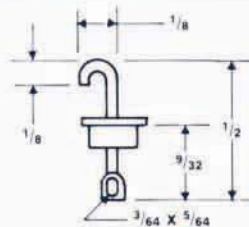

HE40

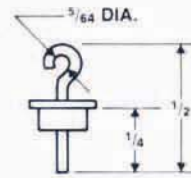

LS40

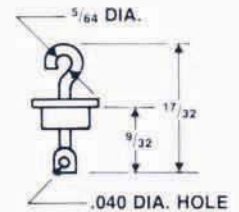

LP40

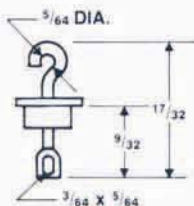

LE40

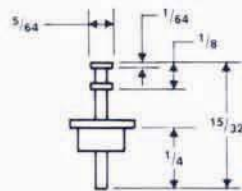

THS40

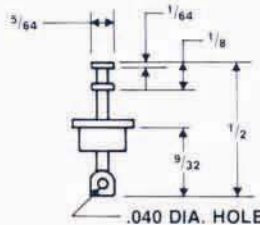

THP40

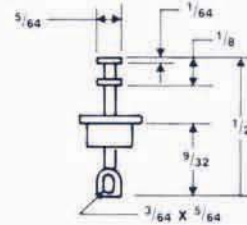

THE40

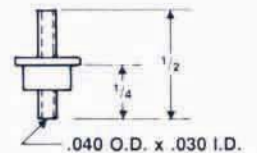

TT40

.040 DIA. ELECTRODE

BODY	A	B	C	D	VOLTAGE R.M.S.
1006	.112	.135	.075	.015	1200
1031	.123	.155	.070	.014	1000
1033	.123	.200	.070	.014	1000
1035	.125	.175	.067	.010	1000
1078	.150	.175	.067	.012	1250
1052	.150	.220	.110	.010	1250
1051	.150	.220	.120	.025	1250
1057	.182	.230	.070	.015	1875
1141	.194	.250	.094	.010	2000
1151	.218	.312	.100	.020	2250

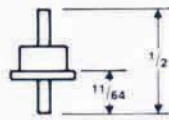
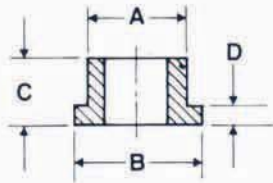

SS40R

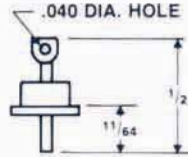

PS40R

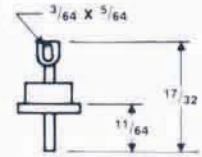

ES40R

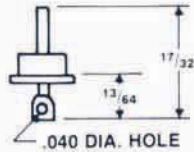

SP40R

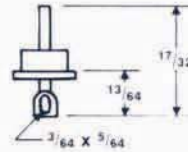

SE40R

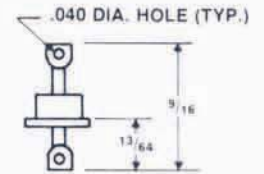

PP40R

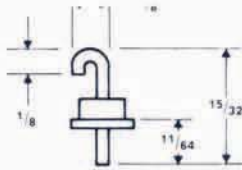

HS40R

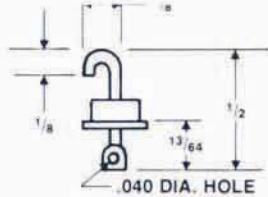

HP40R

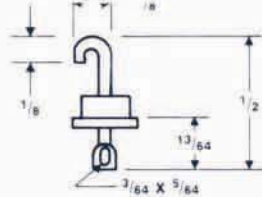

HE40R

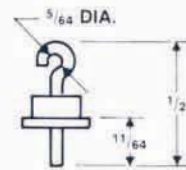

LS40R

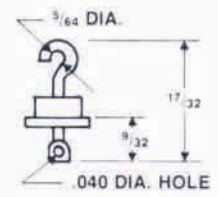

LP40R

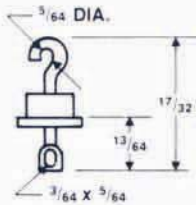

LE40R

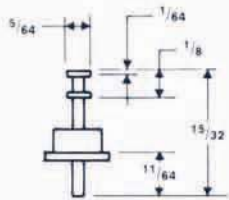

THS40R

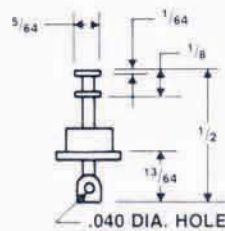

THP40R

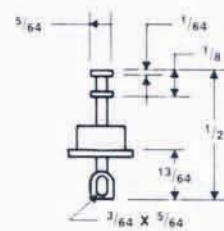

THE40R

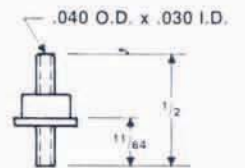

TT40R

.040 DIA. ELECTRODE

BODY	A	B	C	D	VOLTAGE R.M.S.
1006	.112	.135	.075	.015	1200
1031	.123	.155	.070	.014	1000
1033	.123	.200	.070	.014	1000
1035	.125	.175	.067	.010	1000
1078	.150	.175	.067	.012	1250
1052	.150	.220	.110	.010	1250
1051	.150	.220	.120	.025	1250
1057	.182	.230	.070	.015	1875
1141	.194	.250	.094	.010	2000
1151	.218	.312	.100	.020	2250

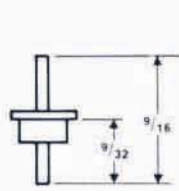
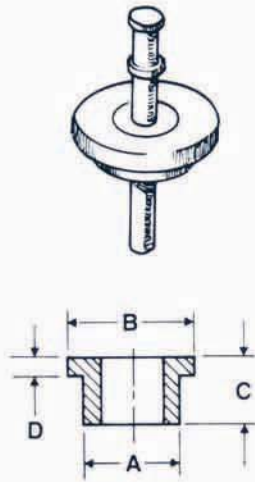

SS60

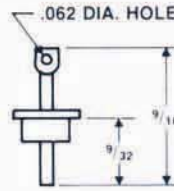

PS60

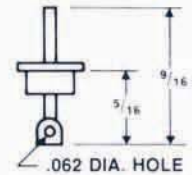

SP60

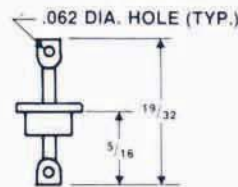

PP60

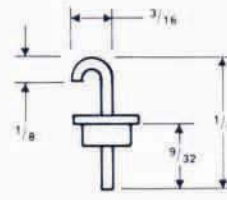

HS60

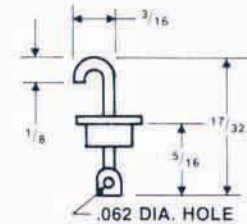

HP60

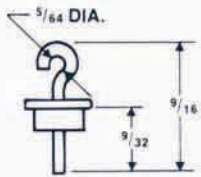

LS60

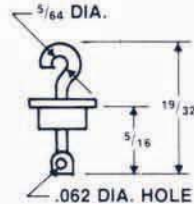

LP60

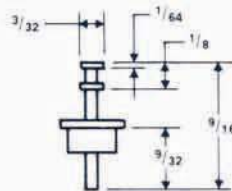

THS60

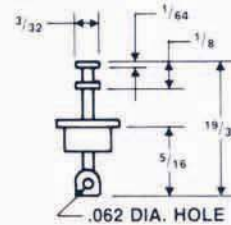

THP60

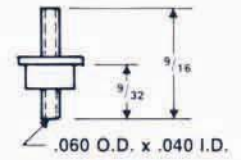

TT60

.060 DIA. ELECTRODE

BODY	A	B	C	D	VOLTAGE R.M.S.
1078	.150	.175	.067	.012	1000
1052	.150	.220	.110	.010	1000
1051	.150	.220	.120	.025	1000
1057	.182	.230	.070	.015	1500
1141	.194	.250	.094	.010	1750
1151	.218	.312	.100	.020	2000
1163	.280	.375	.100	.030	2750
1166	.312	.406	.105	.025	2750

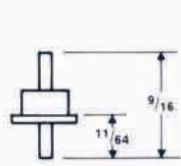
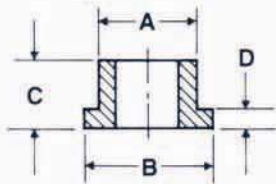
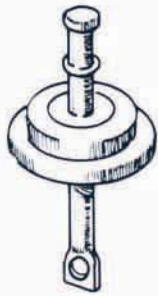

SS60R

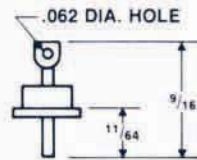

PS60R

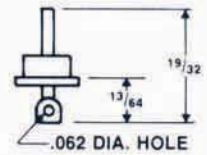

SP60R

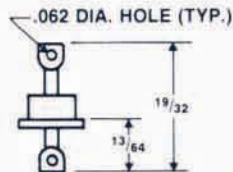

PP60R

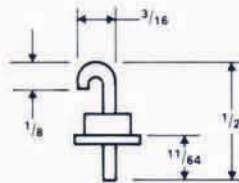

HS60R

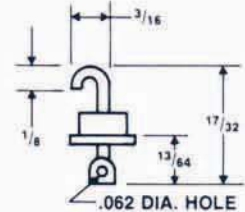

HP60R

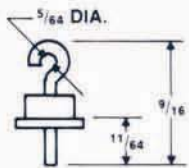

LS60R

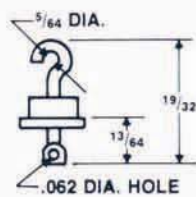

LP60R

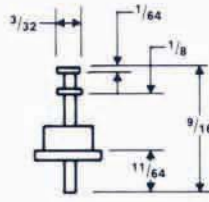

THS60R

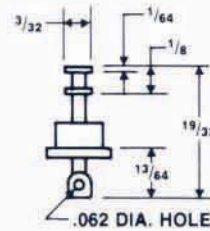

THP60R

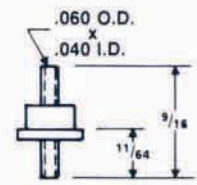

TT60R

.060 DIA. ELECTRODE

BODY	A	B	C	D	VOLTAGE R.M.S
1078	.150	.175	.067	.012	1000
1052	.150	.220	.110	.010	1000
1051	.150	.220	.120	.025	1000
1057	.182	.230	.070	.015	1500
1141	.194	.250	.094	.010	1750
1151	.218	.312	.100	.020	2000
1163	.280	.375	.100	.030	2750
1166	.312	.406	.105	.025	2750

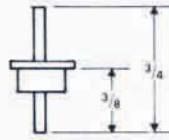
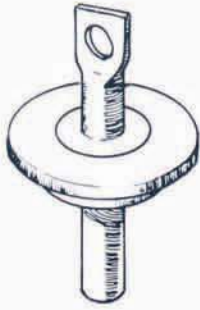

SS93

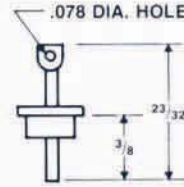

PS93

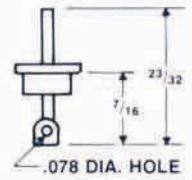

SP93

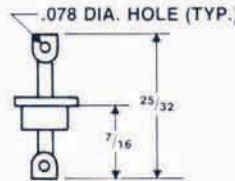
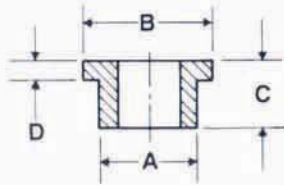

PP93

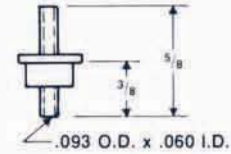

TT93

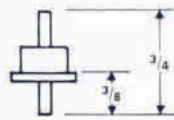
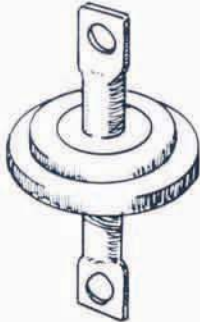

SS93R

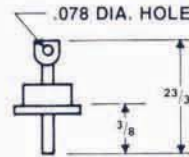

PS93R

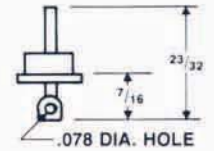

SP23R

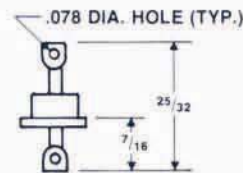
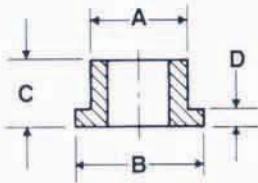

PP93R

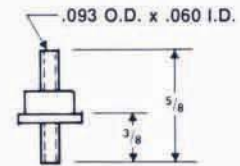

TT93R

.093 DIA. ELECTRODE

BODY	A	B	C	D	VOLTAGE R.M.S.
1057	.182	.230	.070	.015	1000
1141	.194	.250	.094	.010	1250
1151	.218	.312	.100	.020	1500
1163	.280	.375	.100	.030	2000
1166	.312	.406	.105	.025	2000
1173	.370	.406	.125	.040	3000
1171	.370	.500	.105	.030	3000
1170	.380	.403	.125	.045	3000
1182	.420	.550	.105	.040	3000

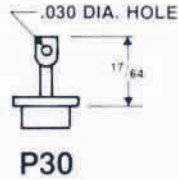
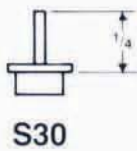

.030 DIA. ELECTRODE

BODY	A	B	C	D	VOLTAGE R.M.S.
1007	.067	.082	.050	.010	500
1021	.093	.102	.055	.005	750
1011	.105	.115	.062	.005	900
1006	.112	.135	.075	.015	1200

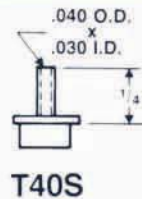
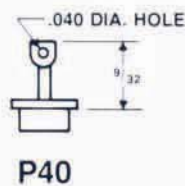
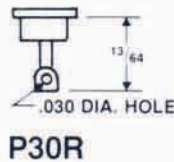
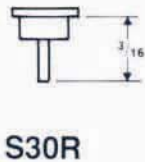
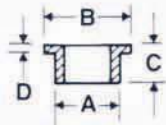

.040 DIA. ELECTRODE

BODY	A	B	C	D	VOLTAGE R.M.S.
1006	.112	.135	.075	.015	1200
1031	.123	.155	.070	.014	1000
1033	.123	.200	.070	.014	1000
1035	.125	.175	.067	.010	1000
1078	.150	.175	.067	.012	1250
1052	.150	.220	.110	.010	1250
1051	.150	.220	.120	.025	1250
1057	.182	.230	.070	.015	1875
1141	.194	.250	.094	.010	2000
1151	.218	.312	.100	.020	2250

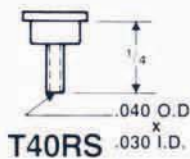
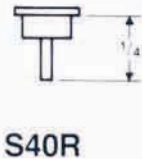
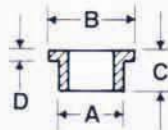

FOR .050 DIA. ELECTRODE
SPECIFY 50 AFTER LETTER (I.E. S50)

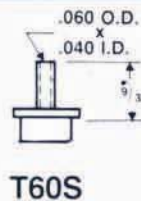
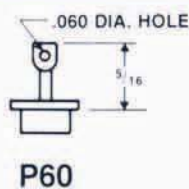

.060 DIA. ELECTRODE

BODY	A	B	C	D	VOLTAGE R.M.S.
1078	.150	.175	.067	.012	1000
1052	.150	.220	.110	.010	1000
1051	.150	.220	.120	.025	1000
1057	.182	.230	.070	.015	1500
1141	.194	.250	.094	.010	1750
1151	.218	.312	.100	.020	2000
1163	.280	.375	.100	.030	2750
1166	.312	.406	.105	.025	2750

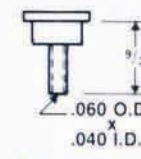
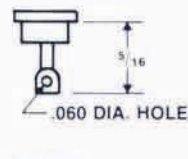
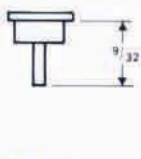
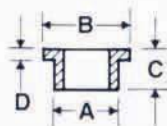

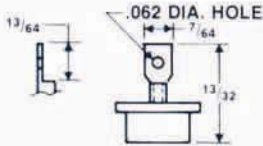

TL60

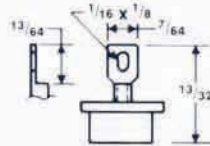

TL60ES

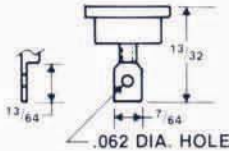
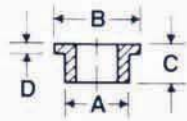

TL60R

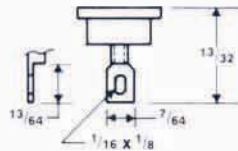

TL60ESR

.060 O.D. x .040 I.D. TUBE

BODY	A	B	C	D	VOLTAGE R.M.S.
1057	.182	.230	.070	.015	1000
1141	.194	.250	.094	.010	1250
1151	.218	.312	.100	.020	1500
1163	.280	.375	.100	.030	2000
1166	.312	.406	.105	.025	2000
1173	.370	.406	.125	.040	3000
1171	.370	.500	.105	.030	3000
1170	.380	.403	.125	.045	3000
1182	.420	.550	.105	.040	3000

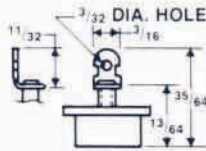

NTL90

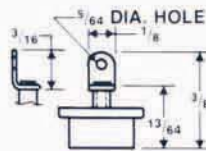

TL90

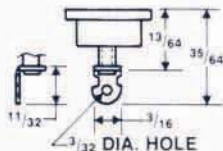
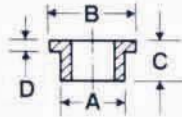

NTL90R

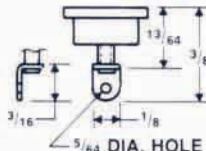

TL90R

.093 O.D. x .060 I.D. TUBE

BODY	A	B	C	D	VOLTAGE R.M.S.
1057	.182	.230	.070	.015	1000
1141	.194	.250	.094	.010	1250
1151	.218	.312	.100	.020	1500
1163	.280	.375	.100	.030	2000
1166	.312	.406	.105	.025	2000
1173	.370	.406	.125	.040	3000
1171	.370	.500	.105	.030	3000
1170	.380	.403	.125	.045	3000
1182	.420	.550	.105	.040	3000

FOR FLAT LUG ADD - 0
 FOR 30° LUG ADD - 30
 FOR 45° LUG ADD - 45

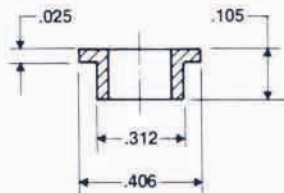

BODY 1166

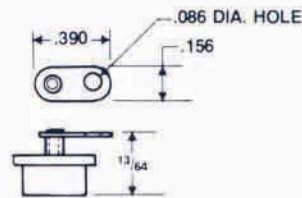

TL93-0

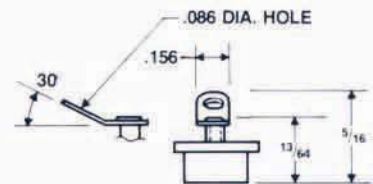

TL93-30

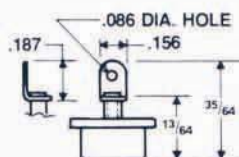

TL93

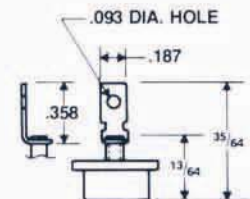

TL93-8

.093 O.D. X .060 I.D. TUBE
 VOLTAGE R.M.S. 2000



AN HCC INDUSTRIES
COMPANY

hcc

HERMETIC SEAL CORP.

4232 Temple City Blvd., Rosemead, CA 91770-1592 • Tel: (626) 443-8931 • FAX: (626) 443-6610